



# HYDROTAP G5 CSHA100 CELSIUS ARC BRUSHED GOLD



CHILLED



SPARKLING



HOT & AMBIENT

FILTERED

UNFILTERED



## Order Code H58765Z07AU

Zip HydroTap Design Range CELSIUS Chilled and Sparkling, Filtered water, plus Hot and Cold washing up water from a single tap. The system features a single under bench command centre including full colour interactive touch screen display with pin code protection and customisable settings including 3 energy saving modes including ON/OFF timers and 2 hour sleep mode, 'Quiet' mode with automated intelligent fan speed adjustment, SteriTouch® antimicrobial protection impregnated into key water paths for enhanced hygiene, 100% water efficient air cooled technology, 0.2 micron water filtration, and a refillable CO2 cylinder. Easy to install integrated ventilation tray included.

Manufacturing Code H58765Z07AU

Capacity Commercial

Combined Chilled and Sparkling Cups per hour 175

Tap Zip HydroTap Design Range CELSIUS ARC Tap (Brushed Gold)

Water Pressure Min 170kPa - Max 700kPa

Water Connection 1/2" BSP (G1/2)

Water Supply Requirements Cold and Hot

Water Valves Integrated 500kPa Pressure limiting valve and Dual Check Valve

Power Rating 0.37kW 220-240V 50Hz

Power Supply 1 x 10 Amp socket outlet

Dimensions W280mm x D476mm x H333mm

Product Approvals

WaterMark, RCM, ARC

Wels Rating

5 Star, 5.5 litres

Warranty

5 years (appliance warranty 36 months plus additional 24 months tank warranty)

## Installation Requirements

1. Installation and connection of your Zip HydroTap must be carried out by a qualified person, observing national and local regulations. 2. You will require suitable mains electrical and drinking water connections, plus waste water drainage all within 1.5 metres of the product. 3. HydroTap is air-cooled so discrete cabinetry cut-outs are required for ventilation. 4. Installation on most bench tops is straightforward however some stone bench tops may require a specialised cutting service. 5. If you live in a hard water area, we recommend installation of a Zip scale filtration kit. 6. Installation by Zip Professional Service can be arranged with a phone call or through [www.zipwater.com](http://www.zipwater.com)

## Installation Detail

BKL2 HydroTap G5 v1.00.02.21 CS100

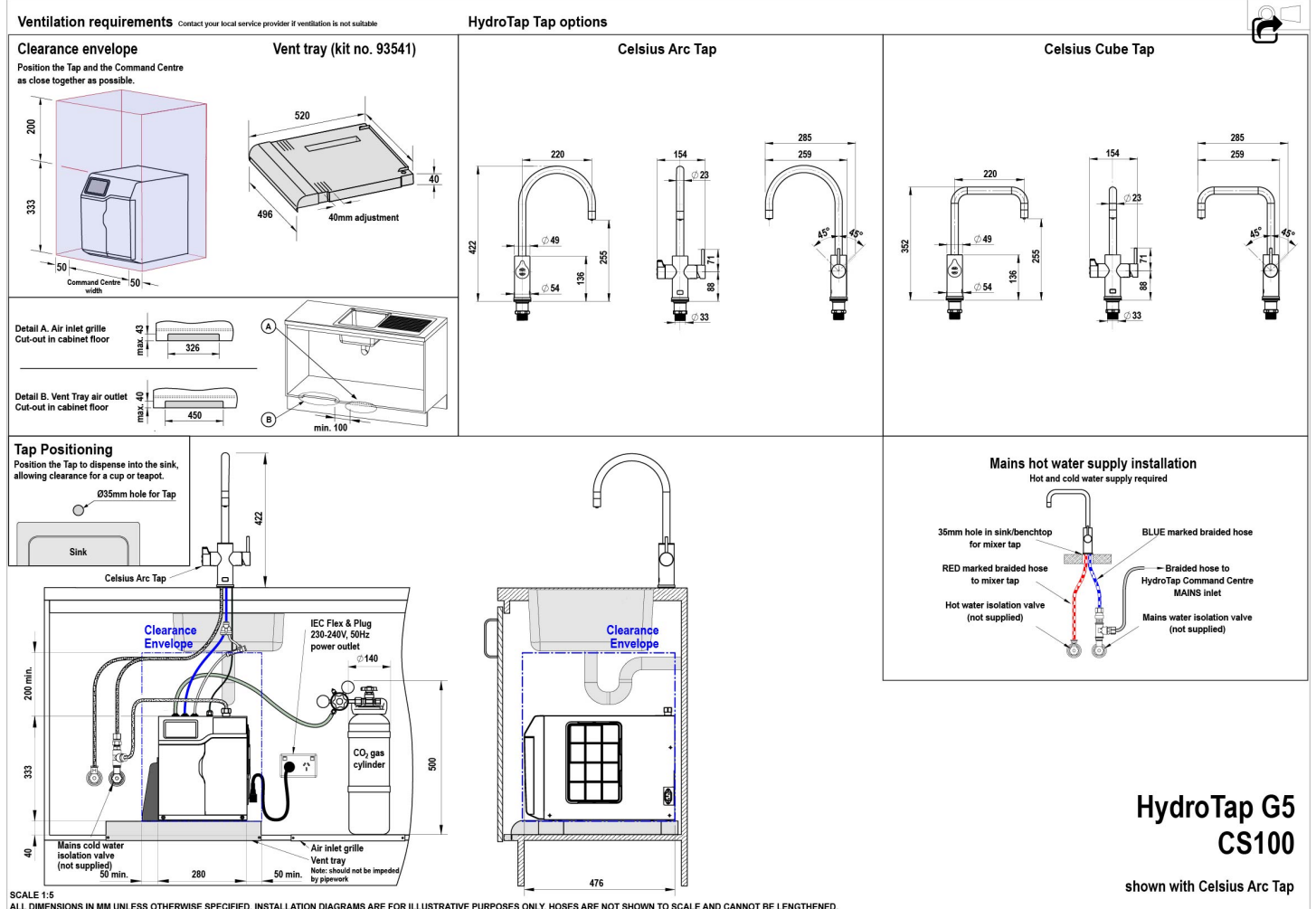

SCALE 1:5  
ALL DIMENSIONS IN MM UNLESS OTHERWISE SPECIFIED. INSTALLATION DIAGRAMS ARE FOR ILLUSTRATIVE PURPOSES ONLY. HOSES ARE NOT SHOWN TO SCALE AND CANNOT BE LENGTHENED.

**HydroTap G5  
CS100**

shown with Celsius Arc Tap

