

Limits unless otherwise stated:

- Fabricated ± 0.75
- Sand-Cast ± 0.35
- Forging ± 0.25
- Die-Cast ± 0.25
- Moulded ± 0.15
- Machined ± 0.25mm
- Angular ± 0.50degree

Fits unless otherwise stated:

- Free Running = H9/d9
- Running = H8/f8
- Clearance = H7/h6
- Sliding = H7/g6
- Interference = H7/u6

Surface finishes unless otherwise stated:

- Sand-Cast = 16.0µm
- Drilling = 6.3µm
- Forging = 6.3µm
- Milling = 3.2µm
- Turning = 3.2µm
- Boring = 3.2µm
- Die-Cast = 1.6µm
- Reaming = 1.6µm
- Grinding = 0.8µm
- Honing = 0.4µm
- Polishing = 0.2µm



Dimensions in millimetres

Drawing to BS8888:2004

Screw threads to BS 8498:2008

Zip Industries Pty Ltd
67 Allingham Street
Condell Park
Sydney
NSW 2200
Australia

Web : www.zipindustries.com
Email : sales@zipindustries.com

Features marked with this symbol: must be referred to in the manufacturing control plan

REVISIONS

Rev	XXXX YYYY	Last Change(s)	ECO	Date	Init
A		First release.	0000	6/12/2012	EVG

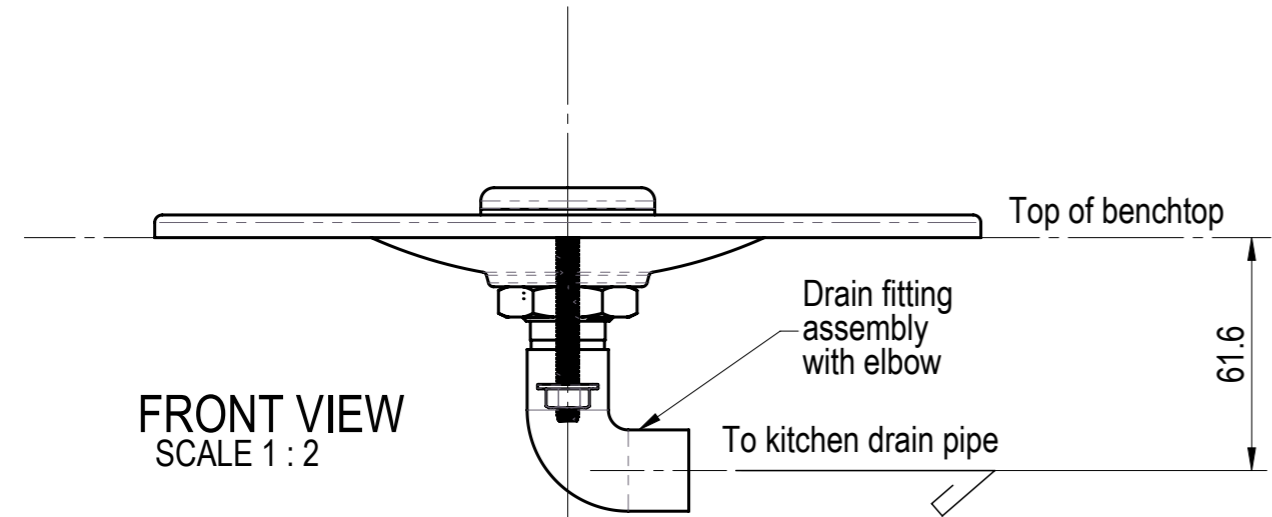
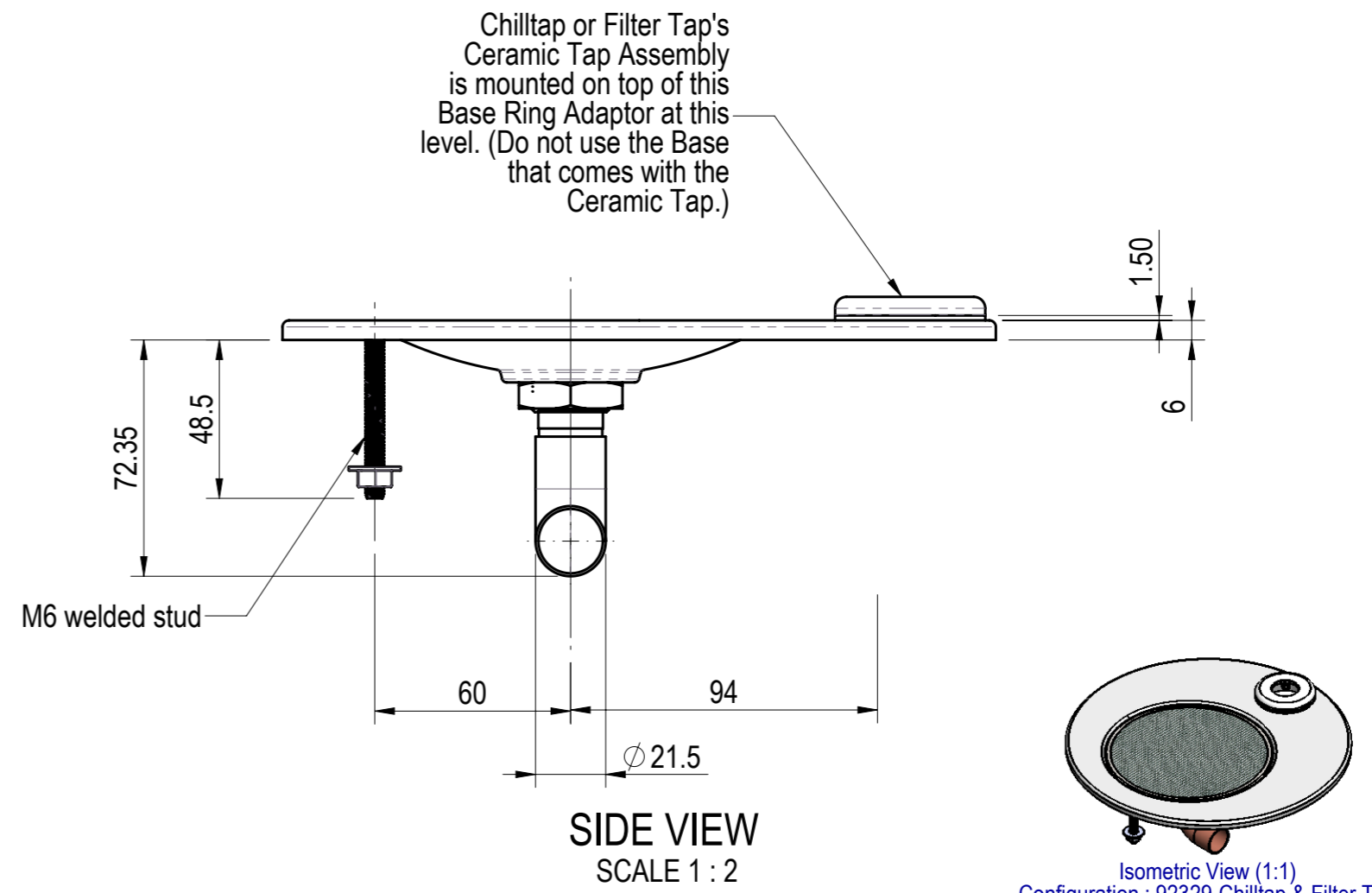
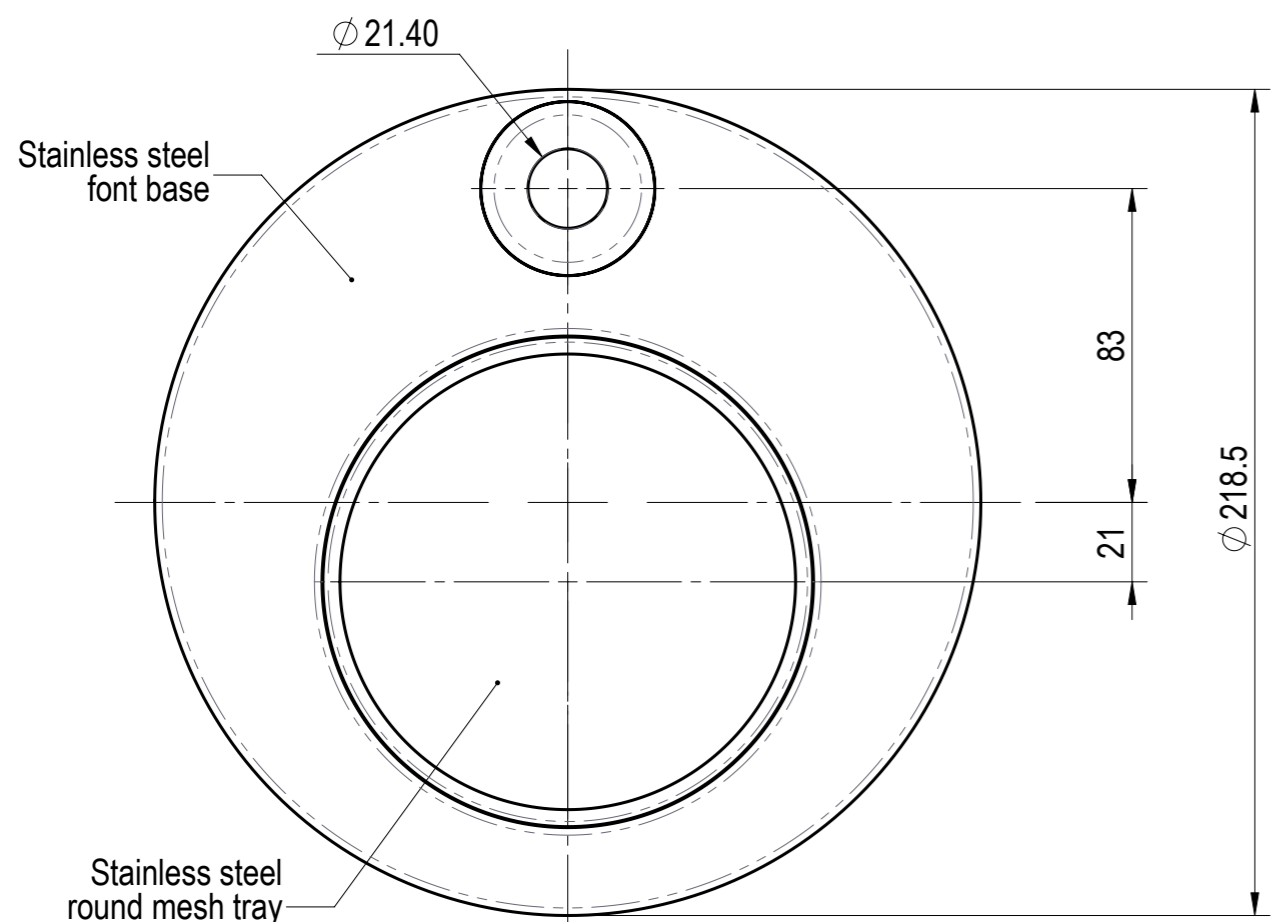

Use 800359 Template Font Mounting-Chilltap/FilterTap to cut the required hole clearances to mount this font assembly on top of a kitchen benchtop.

This drawing is CONFIDENTIAL and is supplied on the express condition that it shall not be LOANED, COPIED or DISCLOSED to any other third party or used for any purpose without the written consent of Zip Industries Pty Ltd. If this document is printed in hardcopy form, it is for INFORMATION ONLY and therefore not subject to updating controls. For the current revision ALWAYS refer to the NATIVE electronic form as stated in the top left-hand corner of this sheet. © copyright Zip Industries Pty Ltd, 17/05/2012



Manufacturing Instructions			Approved by : Unapproved on 1/01/2001			Description :		
Make or Buy : Make	Checked by : Unchecked on 1/01/2001		Font Kit - Chilltap & Filter Tap					
Manufacturing Route : See Components	Updated by : nickm on 30/01/2013 9:35:52 AM		Project : HydroTap®	Configuration :	92329-Chilltap & Filter Tap			
Raw material : See Components	Material : See Components		Model : 900461	Created by & on	edgarg on 28/01/2010			
Remove all sharp edges. This drawing ONLY details information which cannot be ascertained from the 3D geometry of the part(s) attached. Model & dimensions are AFTER all finishing operations	Finish : See Components		Drawing : 92329		Created by & on	Engineer on 17/05/2012		
Comments : Converted by nickm @ 10/05/2012 14:53:38	Volume (cm³) : 85.9	Area (cm²) : 1436.5	Derived from : New	Colour : Proprietary	Rev A			
Potable? No	Recyclable? No	Handed? No	Mass (g) : 495.1	Density (g/cm³) : 5.8	Scale : 1:1	Sheet : 1 of 1	Status : Production	Size A3
Drawing Property		Part Property						